

All sitting heights measured without load - a variation may occur depending on the load due to contraction of gas-struts, springs, upholstery and third part equipment. All information herein contained is subject to change without notice unless under contractual configuration control. Please consult Norsap if dimensions are critical or a certified drawing is required.

www.norsap.no

Chair interface:

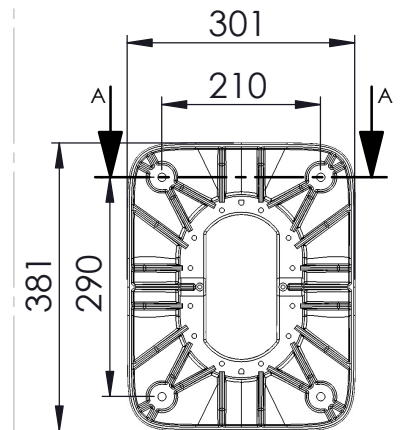
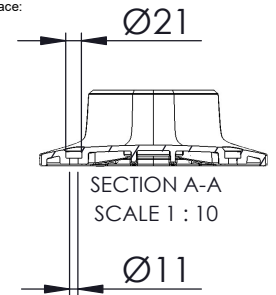

Approx. Weight: 60.00 kg



Mjåvannsvegen 45/47  
NO 4626 Kristiansand (Norway)

Description:  
**Norsap 1600 Standard S+**

Art.-No.:  
**8610**

Date:  
**01/03/2023**

Revision:  
**A 3**